

Site Plan - Ground Level

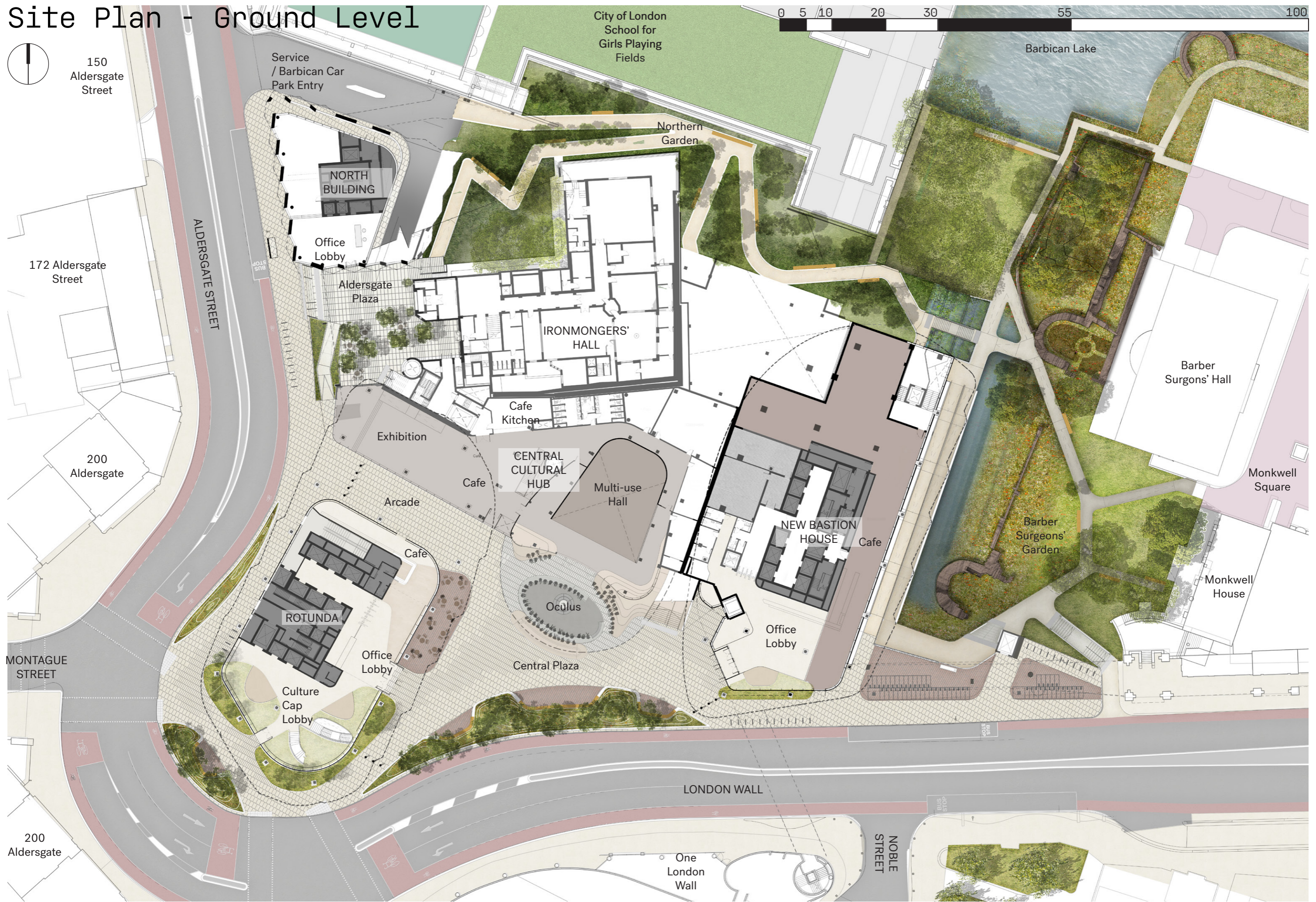

Site Plan - Lower Ground Level



NORTH BUILDING

Ironmongers' Loading Area

IRONMONGERS' HALL

Loading Dock

Loading Dock (below)

Multi-use Hall

NEW BASTION HOUSE

Barber Surgeons' Hall

Monkwell Square

Barber Surgeons' Garden

ROTUNDA

Cycle Parking

Cultural Space

Roman Gate Viewing Area

Public Cycle Hub

Barbican Residents' Car Park

Barbican Lake

Site Plan - High Walk Level



150
Aldersgate
Street

172 Aldersgate
Street

200
Aldersgate

200
Aldersgate

ALDERSGATE STREET

City of London
School for
Girls Playing
Fields

Northern
Garden

NORTH
BUILDING

Office

Aldersgate
Plaza

IRONMONGERS'
HALL

Aldersgate
Flame

Rotunda
Arcade

Highwalk

Maker
Space

NEW
BASTION
HOUSE

[open]

Barbican Lake

Barber
Surgeons' Hall

Monkwell
Square

Barber
Surgeons'
Garden

Monkwell
House

Glade

Oculus

Conference
Suite

ROTUNDA

[open]

Public
Lounge

[open]

LONDON WALL

NOBLE
STREET

One
London
Wall

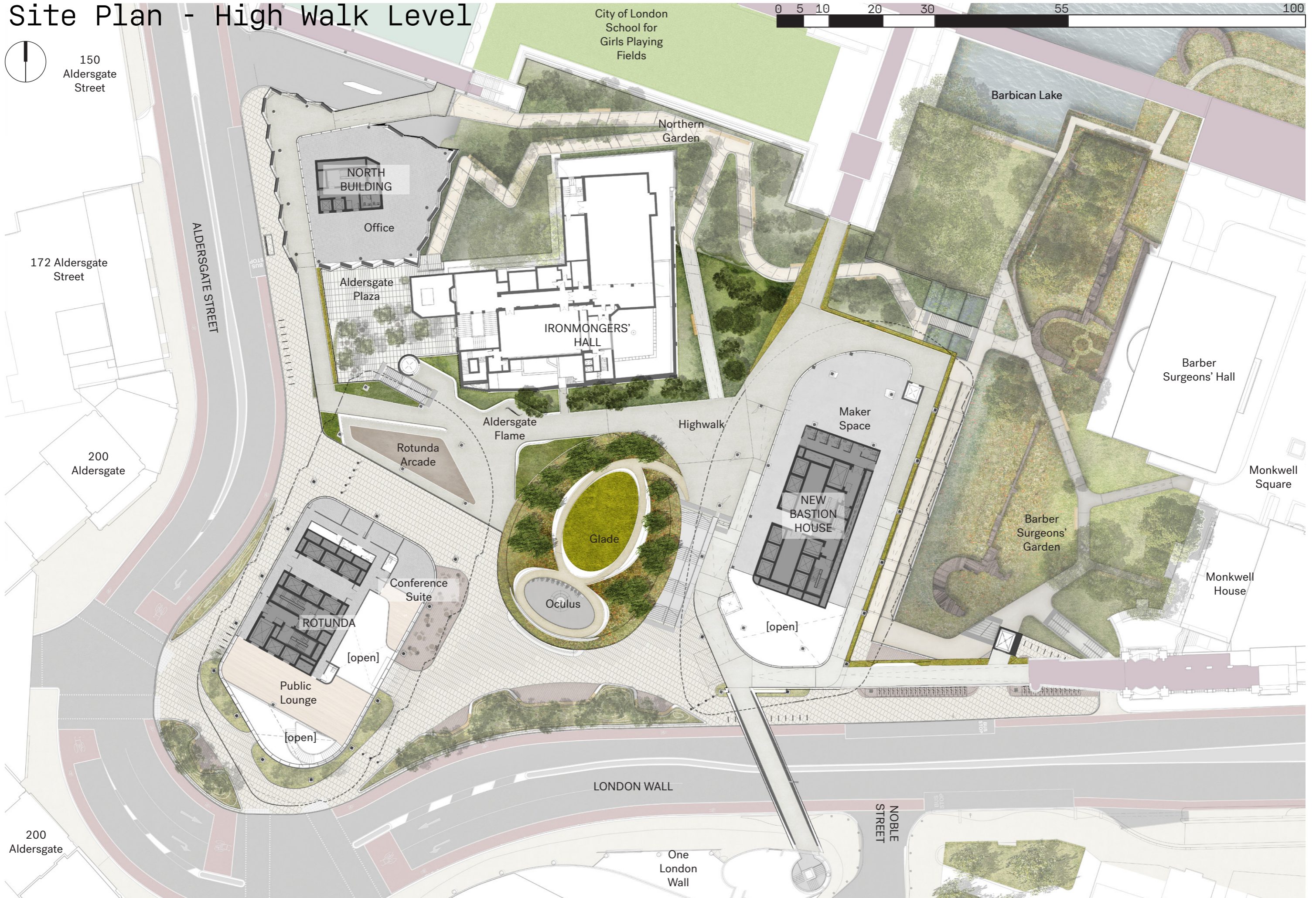



PUBLIC REALM AXONOMETRIC

Public Realm Uplift

PUBLIC REALM AREAS						
	Existing (sqm)			Proposed (sqm)		
	Hardscape	Landscape	Total	Hardscape	Landscape	Total
P / 00H	2,800	521	3,321	2,728	2,027	4,755
UG / 00	2,386	590	2,976	4,049	1,385	5,434
LG	360	2,423	2,783	759	2,084	2,843
Total sqm	5,546	3,534	9,080	7,536	5,496	13,032
Total sqft	59,697	38,040	97,736	81,117	59,158	140,275

Area Difference (sqm)		
Hardscape	Landscape	Total
-72	1,506	1,434
1,663	795	2,458
399	-339	60
Total sqm	1,990	3,952
Total sqft	21,420	42,539

The proposal achieves an overall uplift for total public realm area of 43.5%

Note - this figure does not include the public terrace area at Rotunda (12th Floor)

Public Realm Uplift

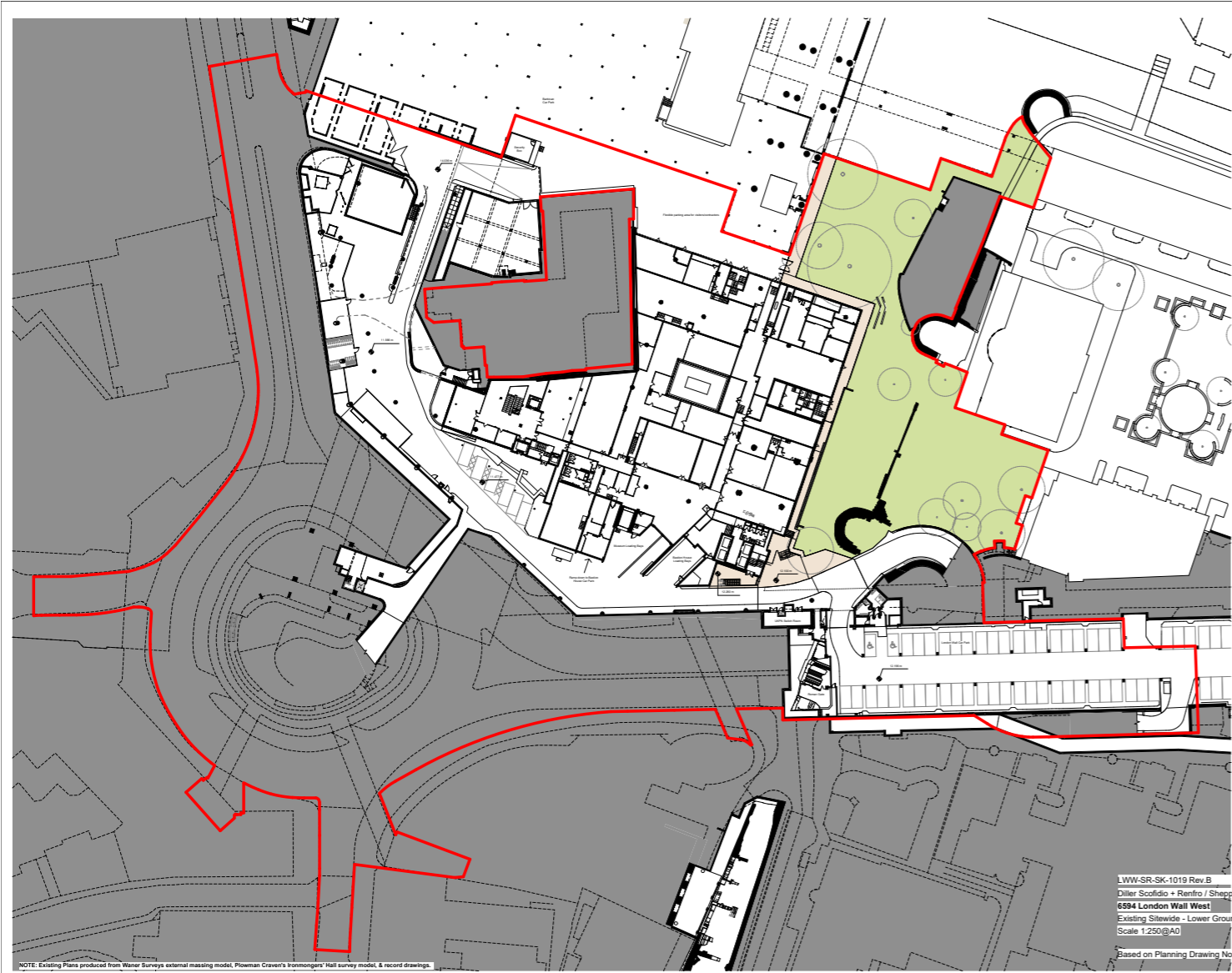

Existing

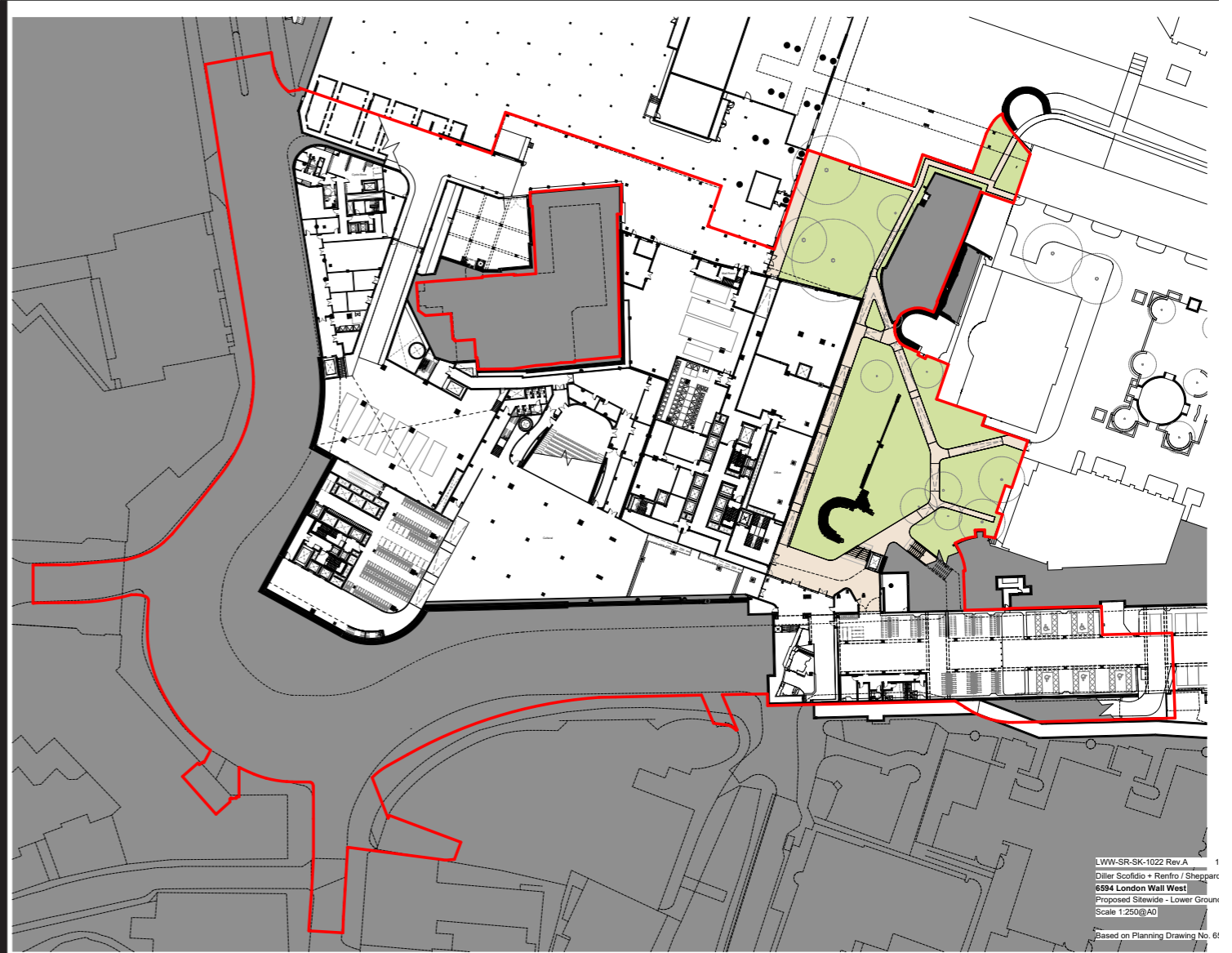

Proposed

- PUBLIC REALM**
- Landscape Area = 2,423 sqm
 - Hardscape Area = 360 sqm
- Application Boundary for Planning Permission (Ground Floor and Below)

Public Realm Uplift

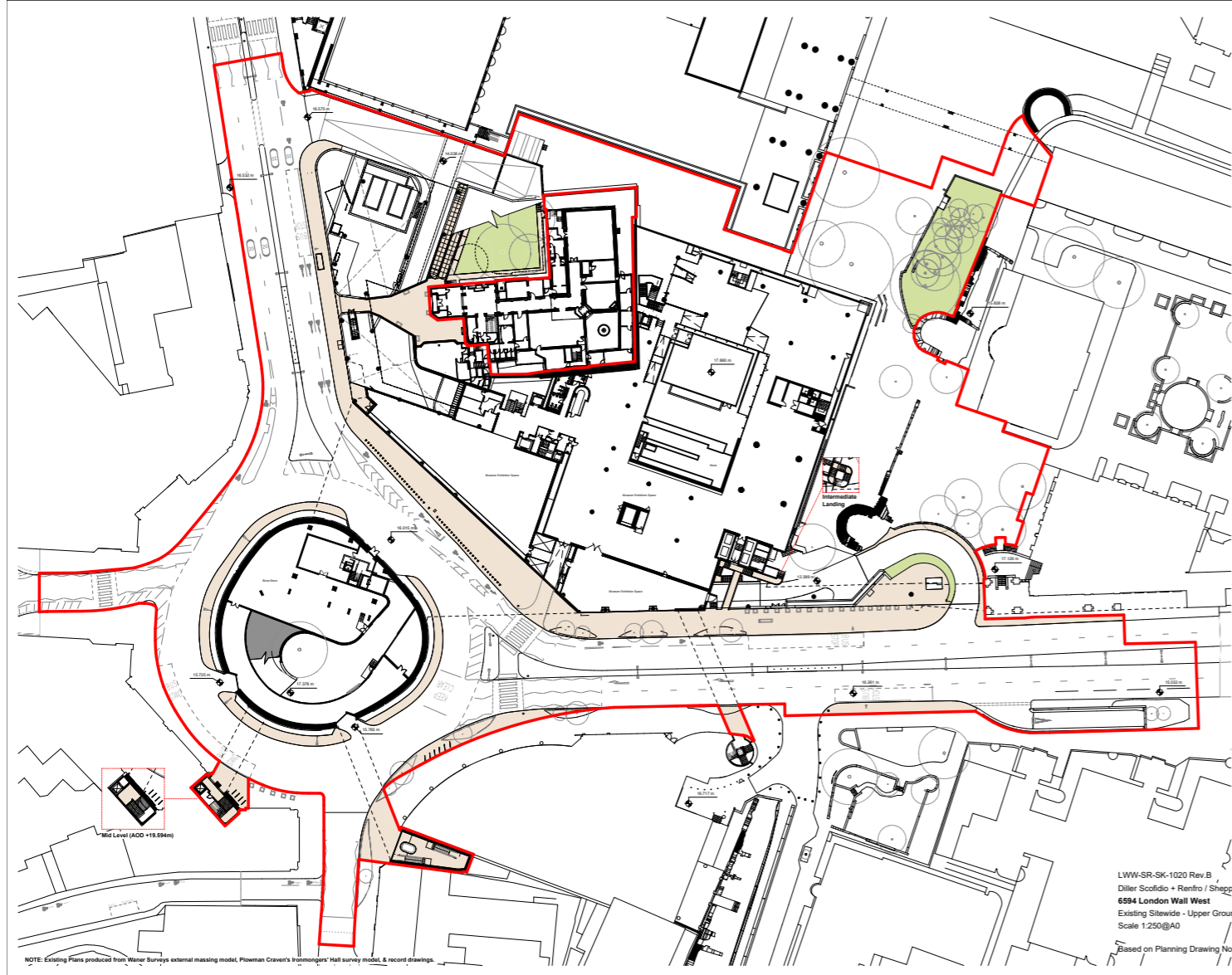

Existing

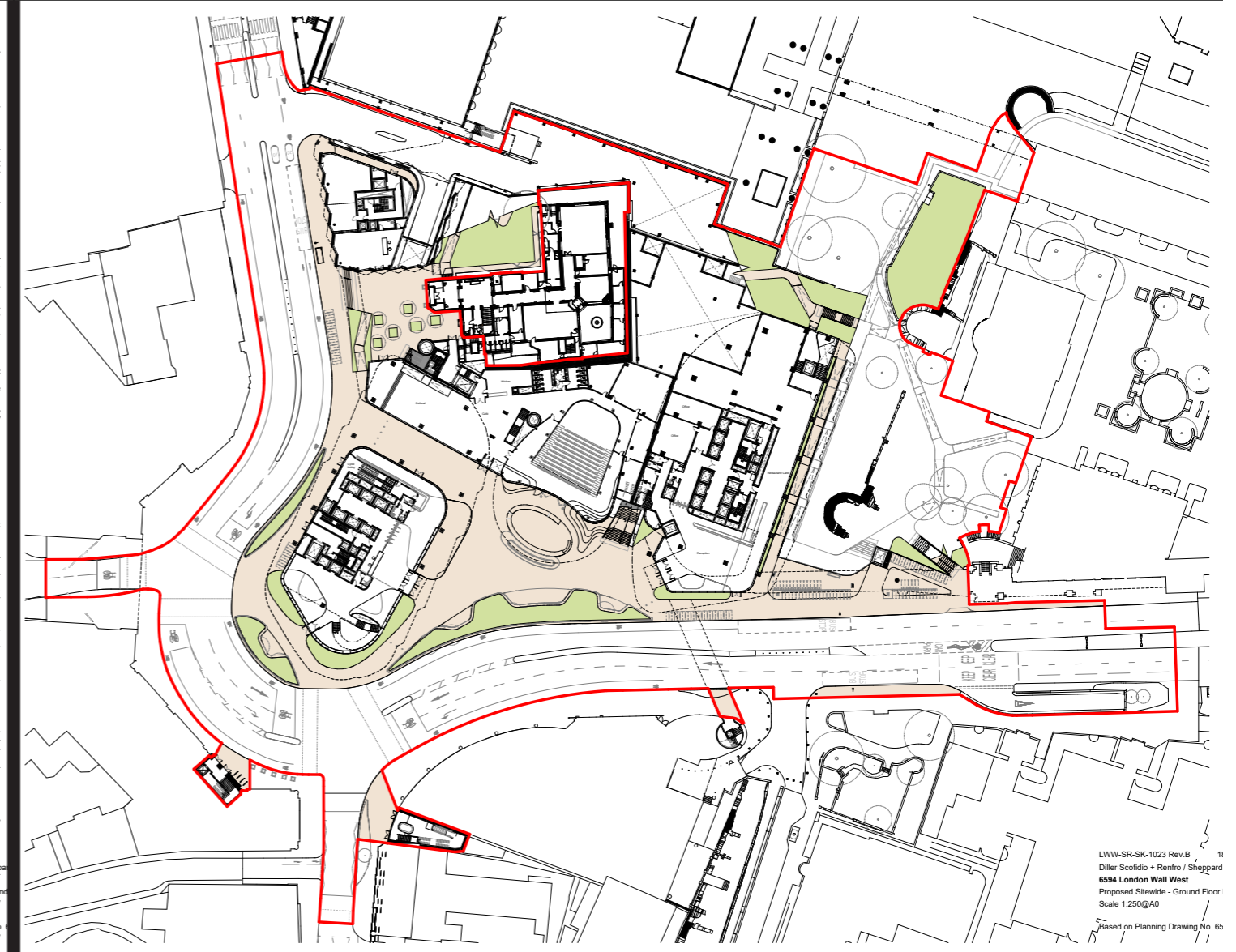

Proposed

- PUBLIC REALM**
- Landscape Area = 2,423 sqm
 - Hardscape Area = 360 sqm
 - Application Boundary for Planning Permission (Ground Floor and Below)

Public Realm Uplift

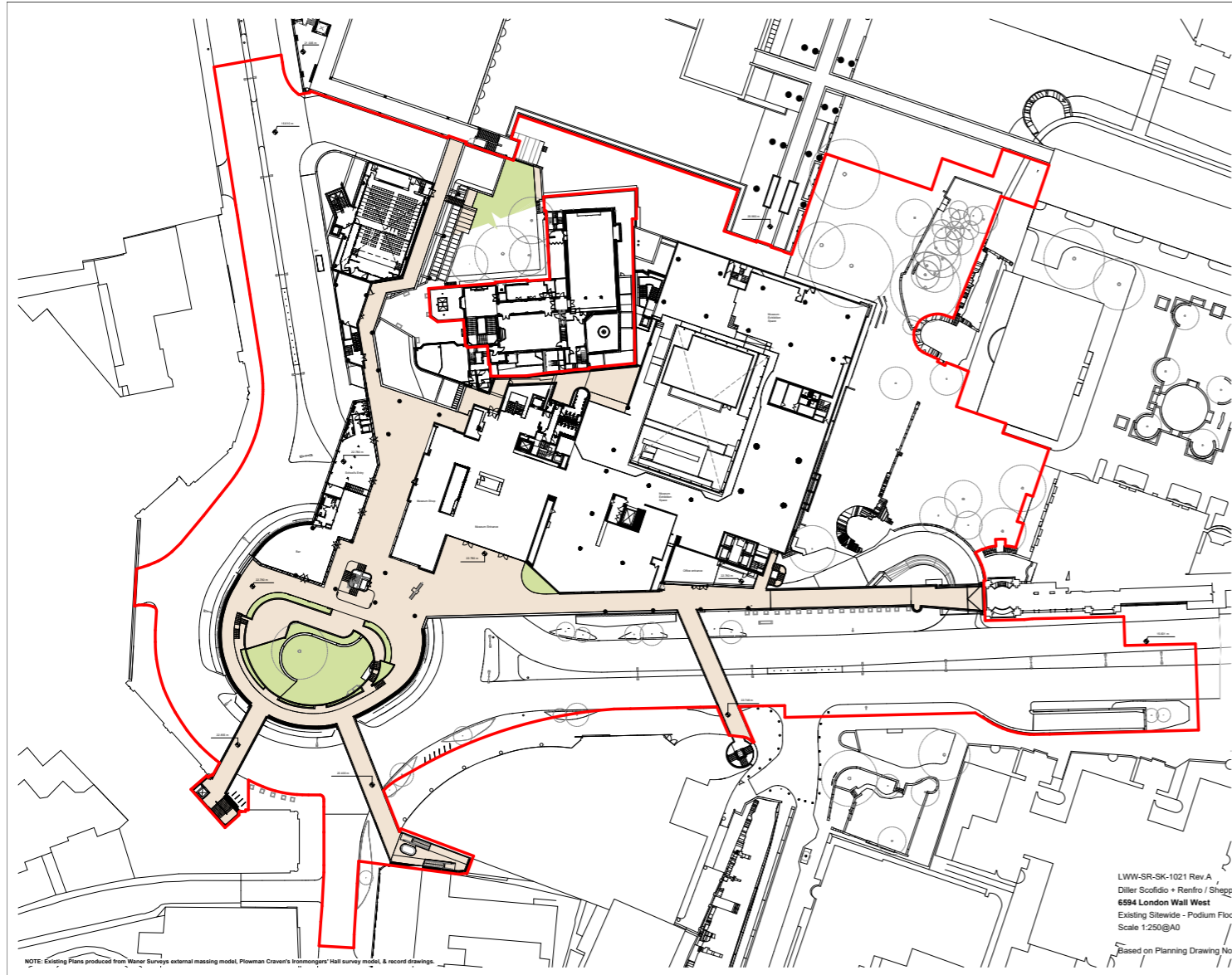

Existing

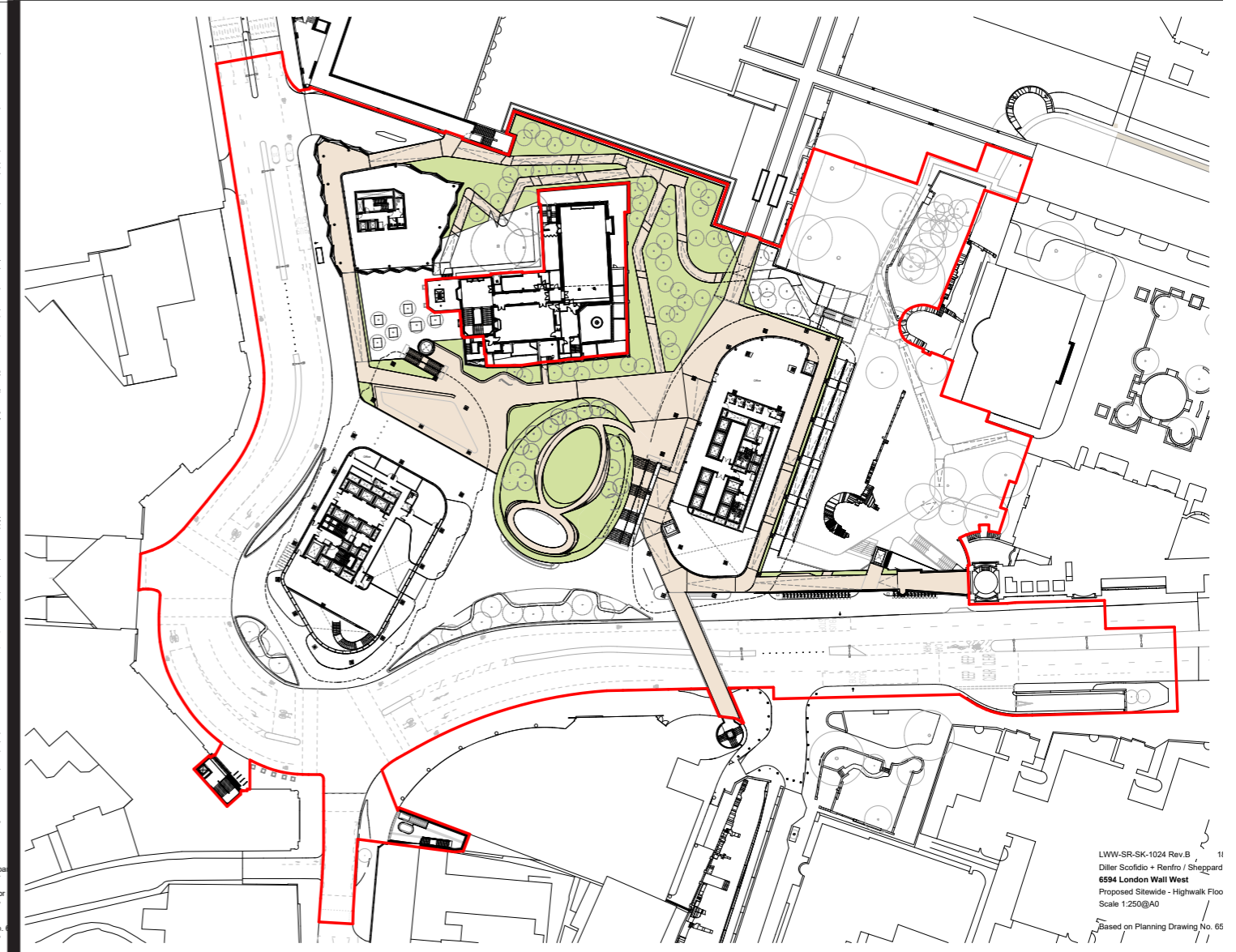

Proposed

- PUBLIC REALM**
- Landscape Area = 2,423 sqm
 - Hardscape Area = 360 sqm
 - Application Boundary for Planning Permission (Ground Floor and Below)

Access and Circulation

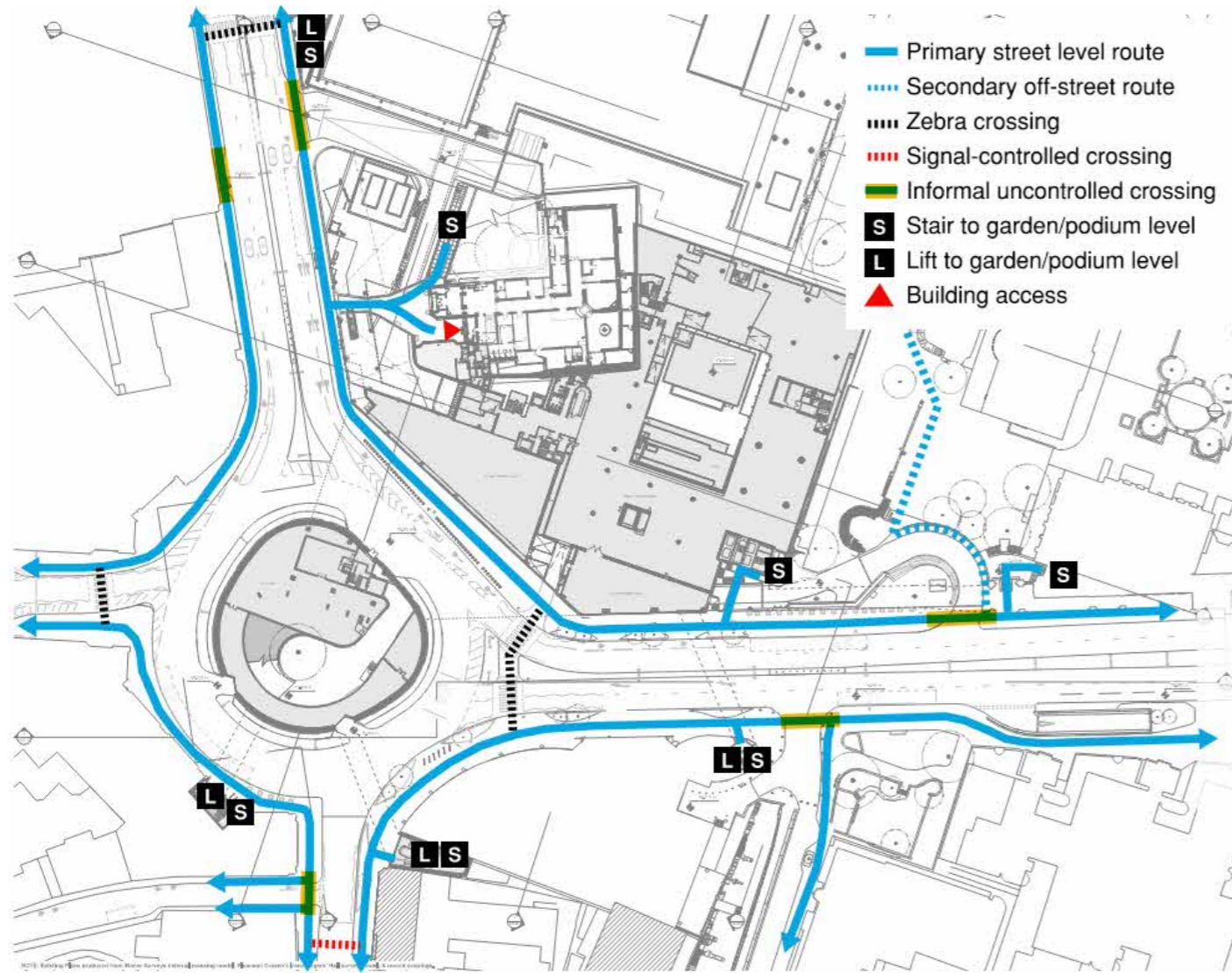

Existing

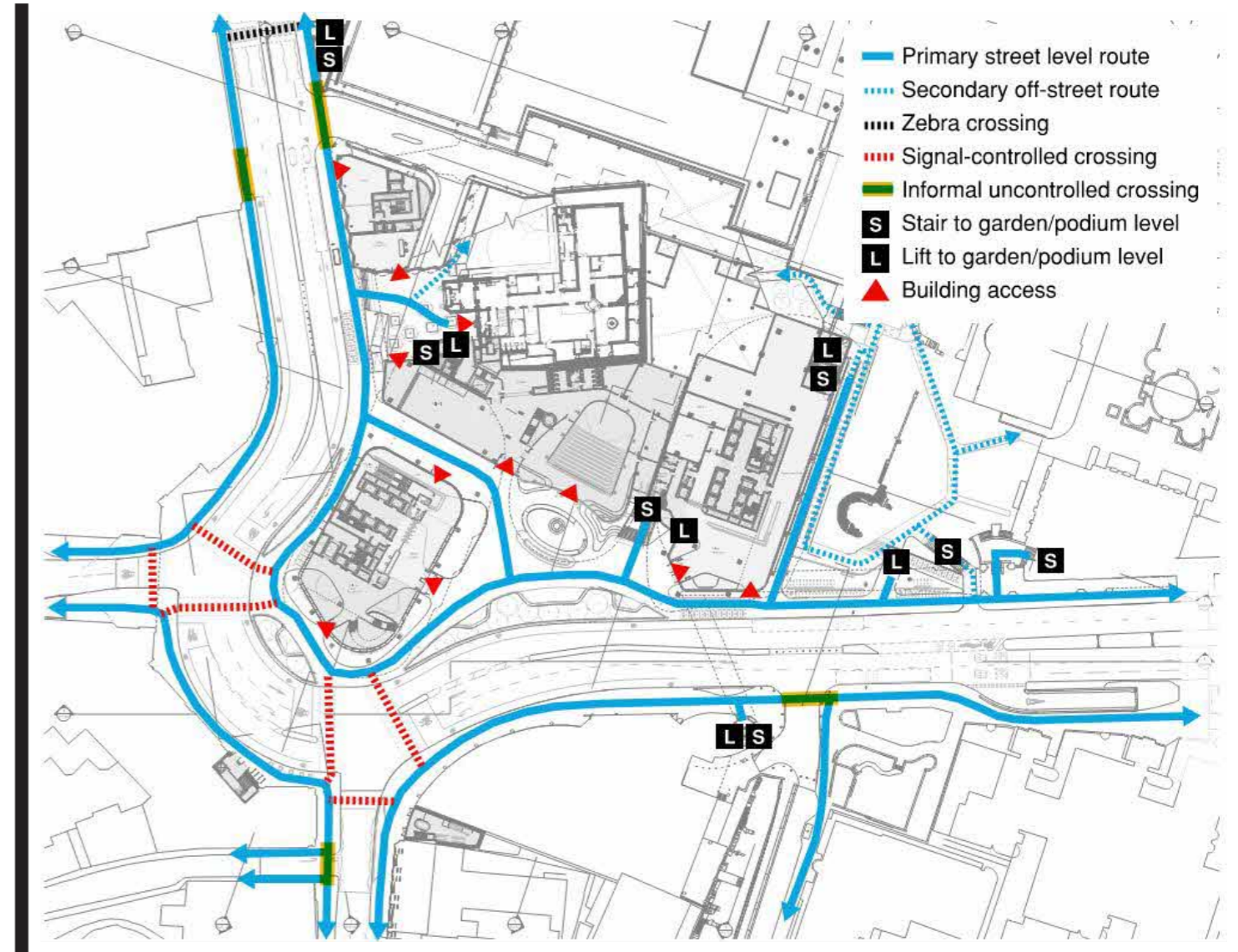

Proposed

Existing (left) and Proposed (right) Street level access and circulation

Access and Circulation

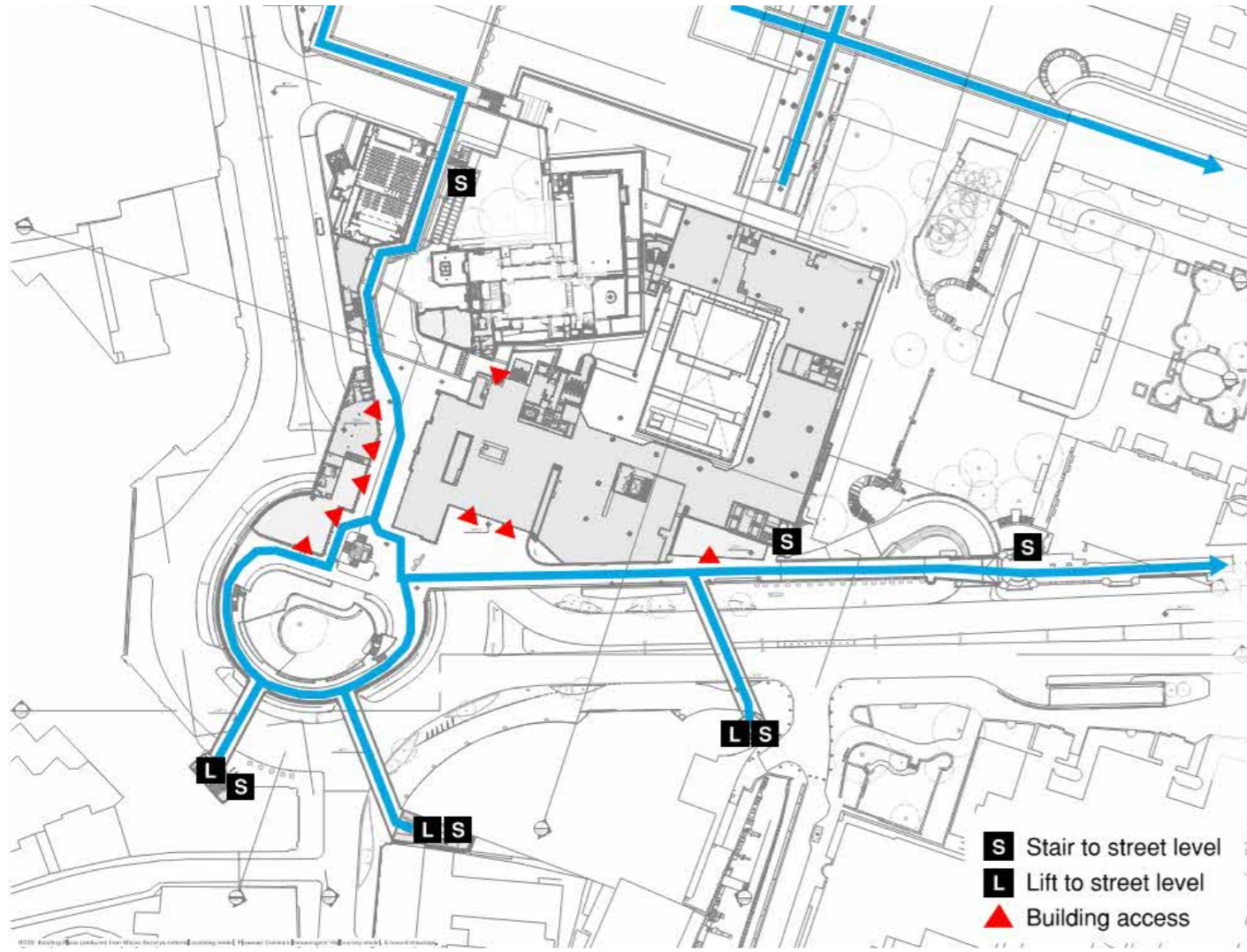

Existing

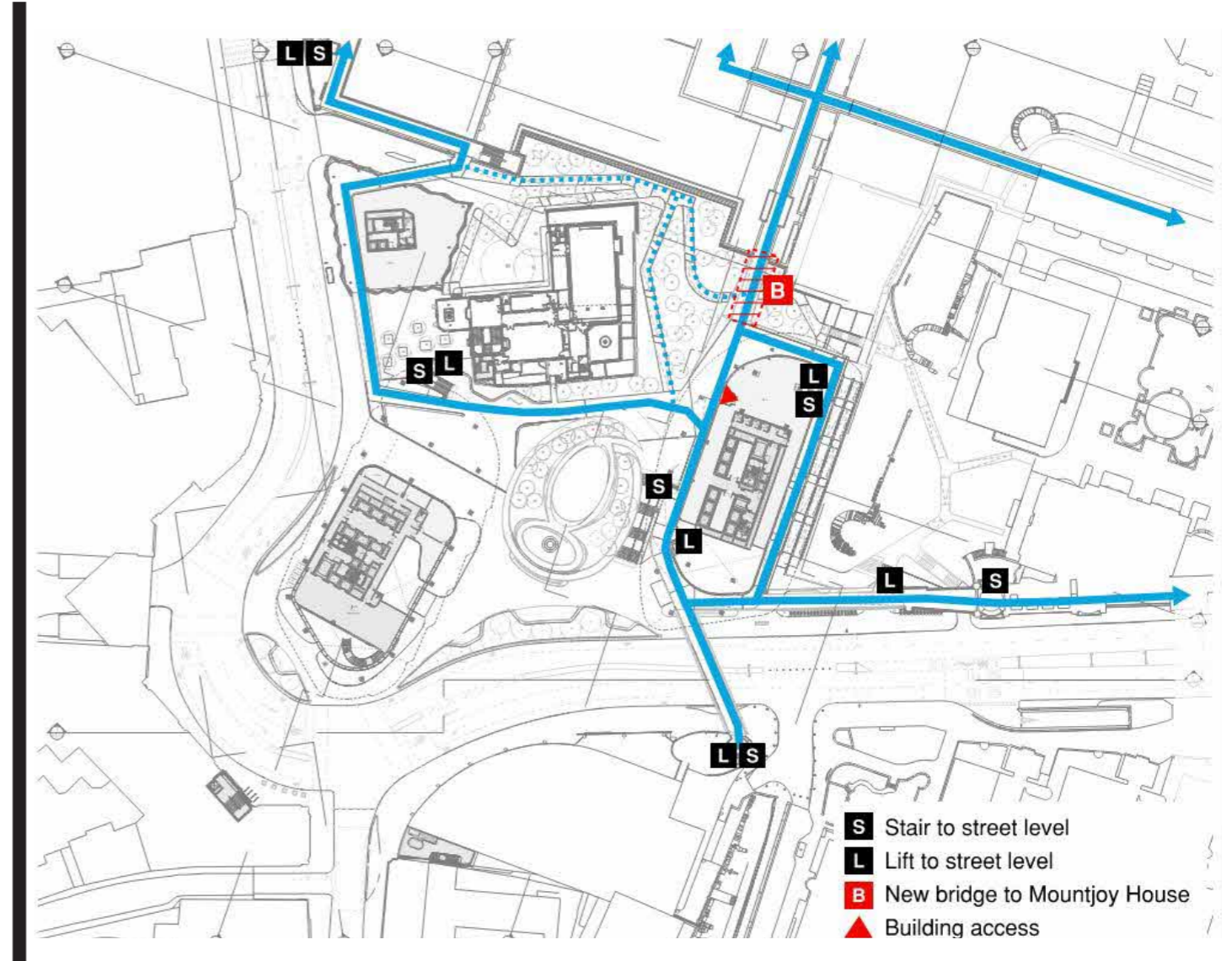

Proposed

Existing (left) and Proposed (right) Highwalk level access and circulation

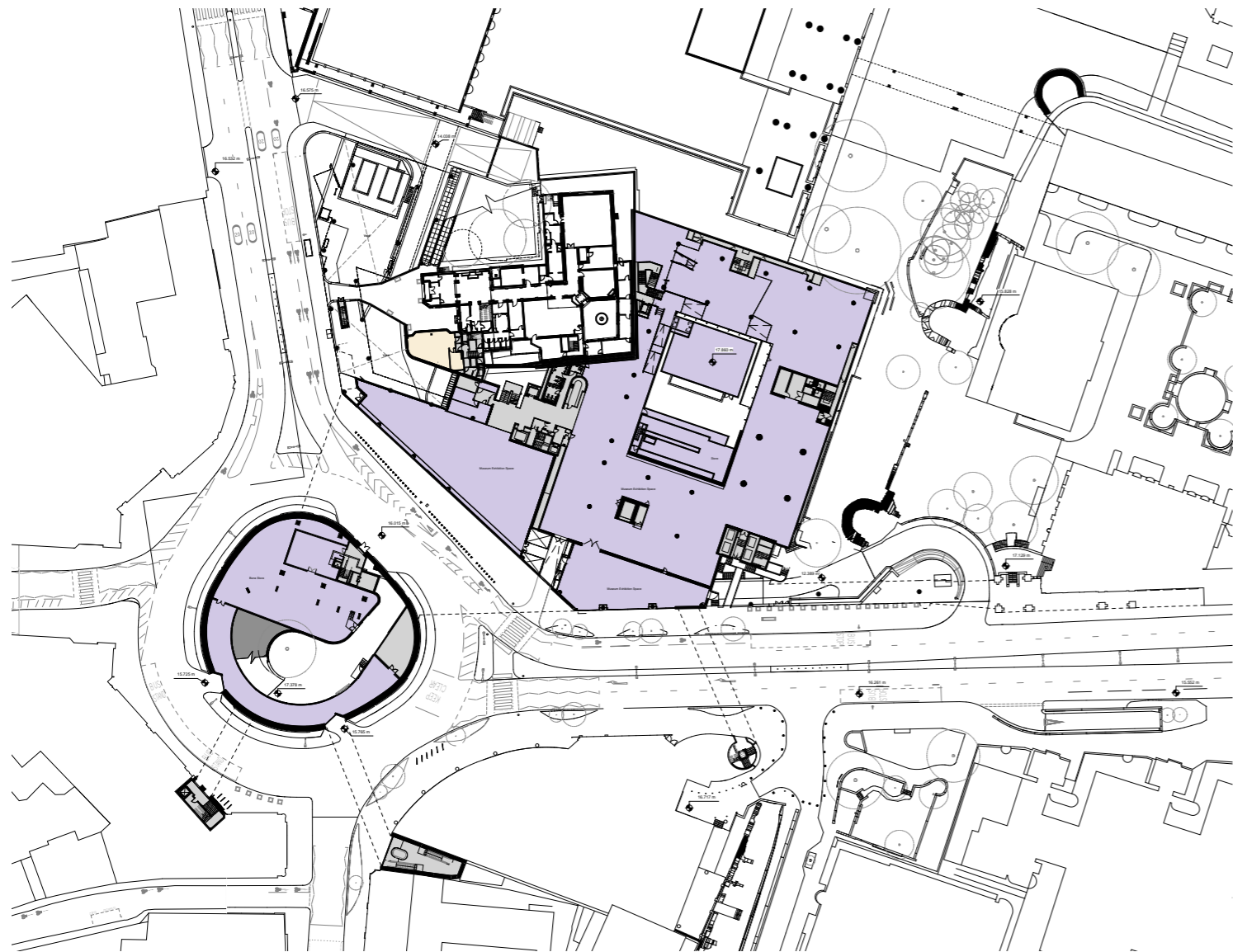

Existing

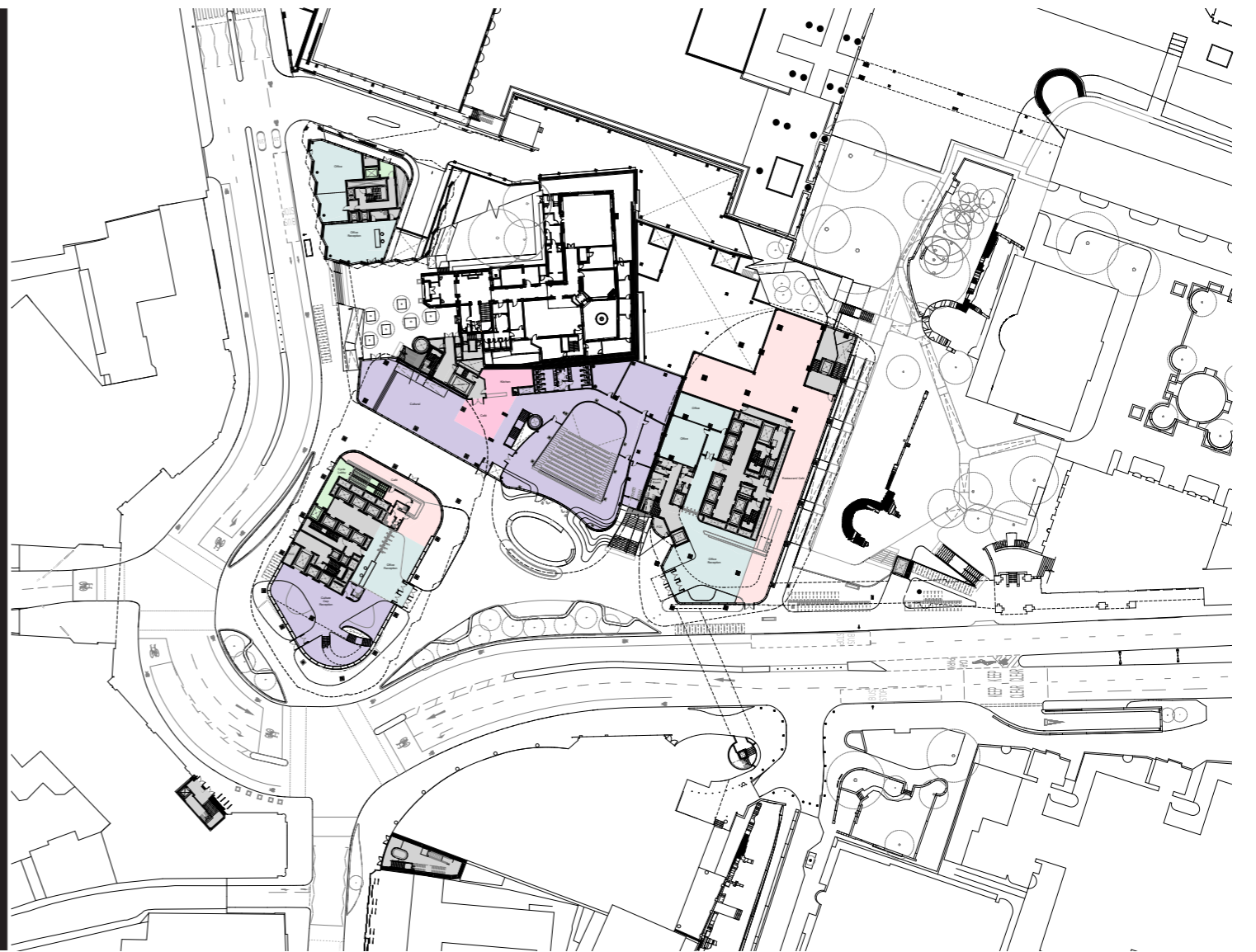

Proposed

KEY

- Office
- Cultural
- Cultural Restaurant / Café
- Restaurant / Café
- Cycle Store
- Shower / Changing Room
- Livery Hall

Existing (left) and Proposed (right) Ground Floors

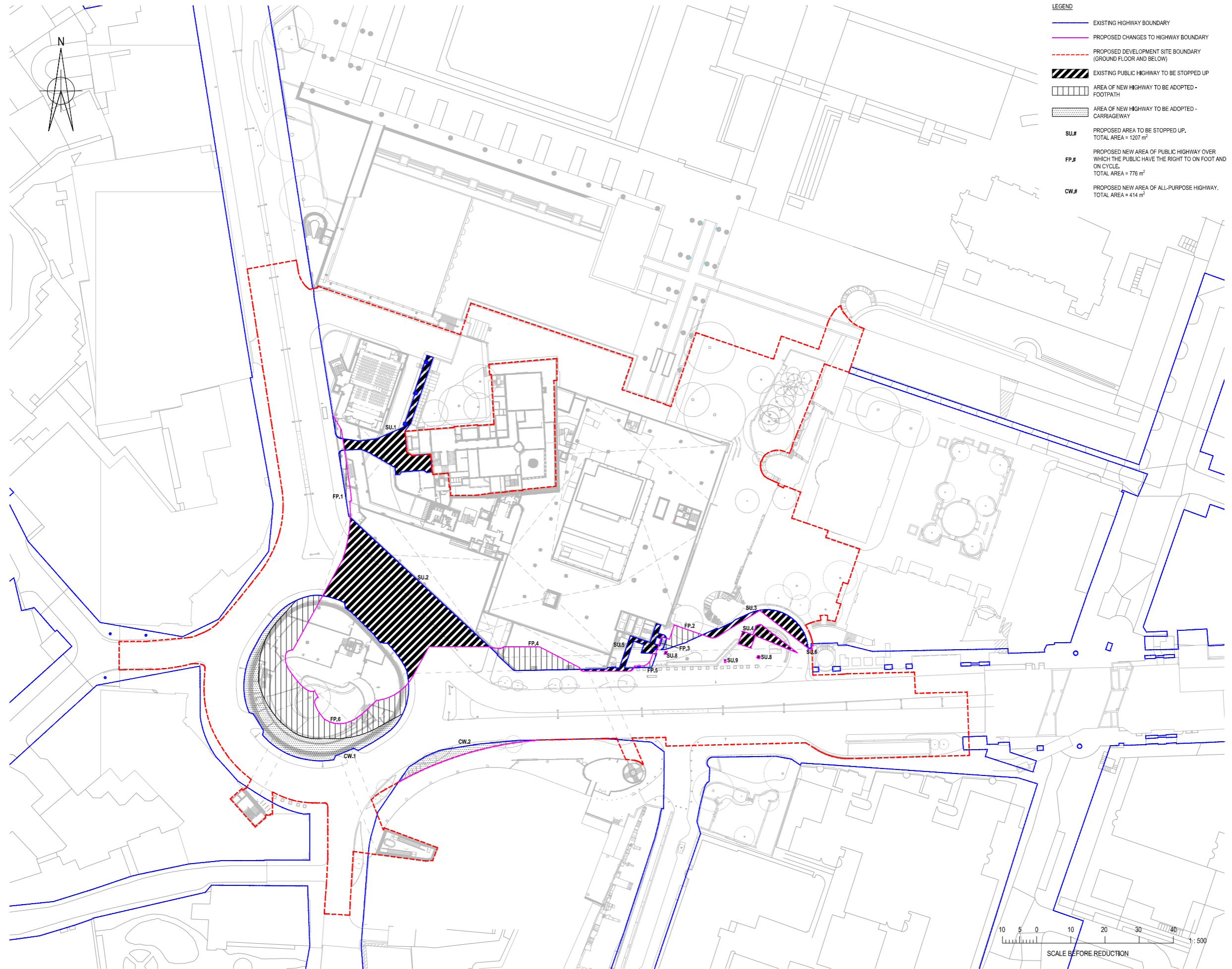

Stopping Up Drawing